

Leetwater HOUSE 13



This impressive four bedroom house has a wealth of space and a host of lovely features. With a flexible layout that gives you the option of four or five bedrooms, it makes the perfect executive home. A particularly generous garden, along with a double garage and trellis-covered car port are standard.

208 sqm



Ground Floor

Ground Floor	Metric	Imperial
Living Room	5.88 x 5.58	19'3" x 18'4"
Kitchen / Dining	8.74 x 4.45	28'8" x 14'7"
Entrance/Sun Lounge	4.07 x 3.15	13'4" x 10'4"
Study/Bedroom 4	4.34 x 3.67	14'2" x 12'0"
Shower Room	3.26 x 2.51	10'8" x 8'3"

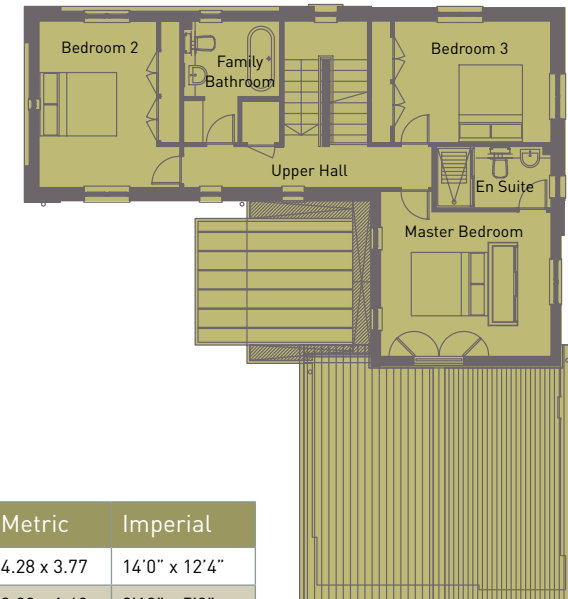

First Floor

First Floor	Metric	Imperial
Master Bedroom	4.28 x 3.77	14'0" x 12'4"
En Suite	3.00 x 1.60	9'10" x 5'3"
Bedroom 2	4.39 x 3.07	14'5" x 10'1"
Bedroom 3	4.08 x 3.17	13'4" x 10'5"
Family Bathroom	3.17 x 2.52	10'5" x 8'3"