

Foulden STEADING 5



A large, west-facing stone extension (actually an original part of the steading) is home to a lovely kitchen and breakfast room. A feature of the upper bedrooms is the high level frosted glass, an elegant contemporary touch in this most elegant of designs.

160 sqm



WHITSOME HILL
MAINS

Ground Floor



Ground Floor	Metric	Imperial
Living Room	5.52 x 4.50	18'1" x 14'9"
Kitchen	5.36 x 4.00	17'7" x 13'1"
Dining/Sun Room	5.17 x 2.88	16'11" x 9'5"
Bedroom 3	4.13 x 3.90	13'6" x 12'9"
Shower/Cloakroom	4.13 x 1.68	13'6" x 5'6"
Utility Room	1.97 x 1.68	6'6" x 5'6"
Vestibule	2.66 x 1.37	8'9" x 4'5"

First Floor

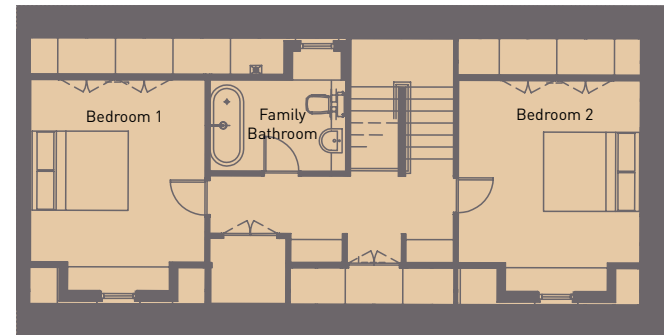

First Floor	Metric	Imperial
Bedroom 1	3.80 x 3.64	12'5" x 11'11"
Bedroom 2	3.80 x 3.78	12'5" x 12'5"
Family Bathroom	2.83 x 1.90	9'3" x 6'3"

All plans in this brochure are for illustrative purposes only and are not drawn to scale. They do not form part of any contract. The dimensions and floor plans given are taken from the architects design proposals and may be subject to change. All dimensions are maximum and are for guidance only. All kitchen, bathroom and En suite layouts are provisional and may be subject to alteration.